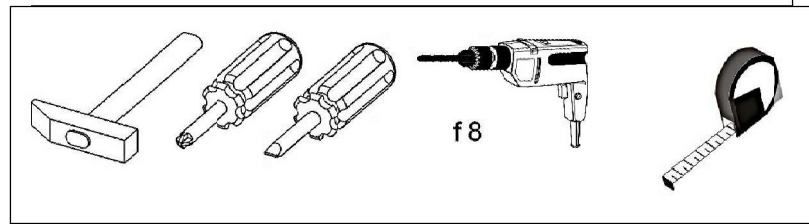


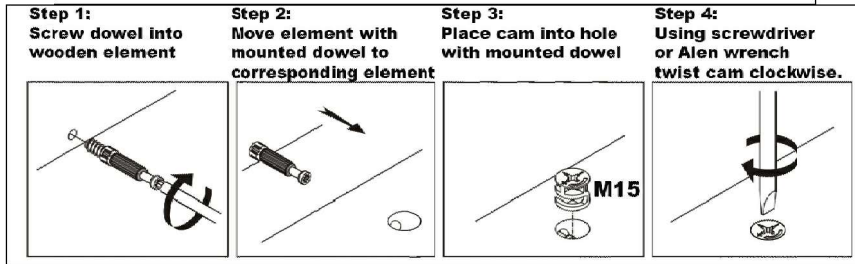
**F11S - Glass
F1IR - Frame**

Outillage nécessaire



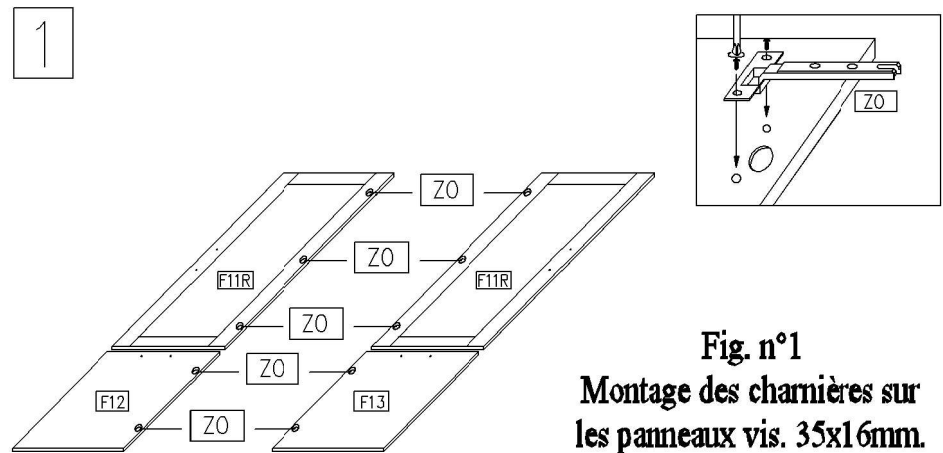
f 8

Principe d'assemblage pas goujon/excentrique



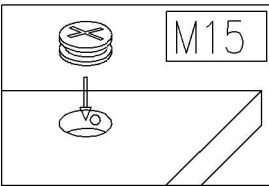
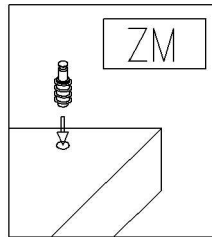
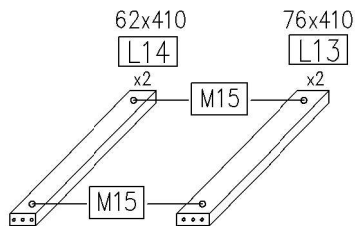
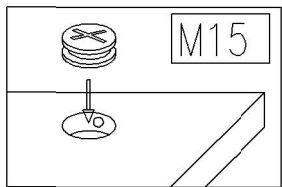
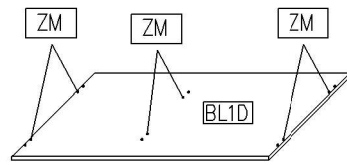
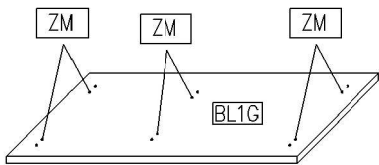
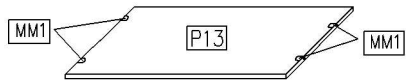
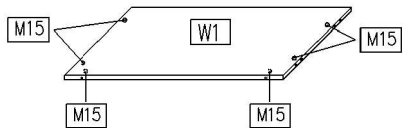
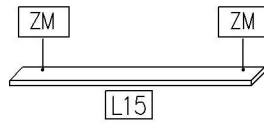
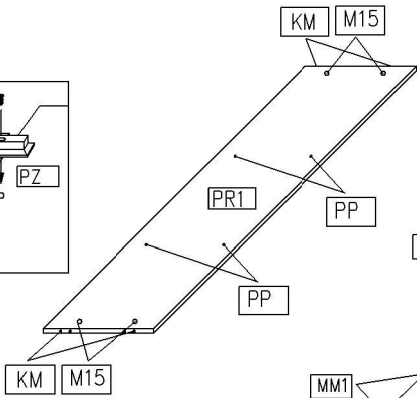
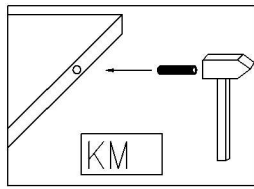
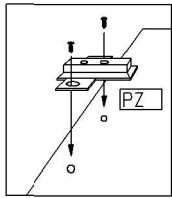
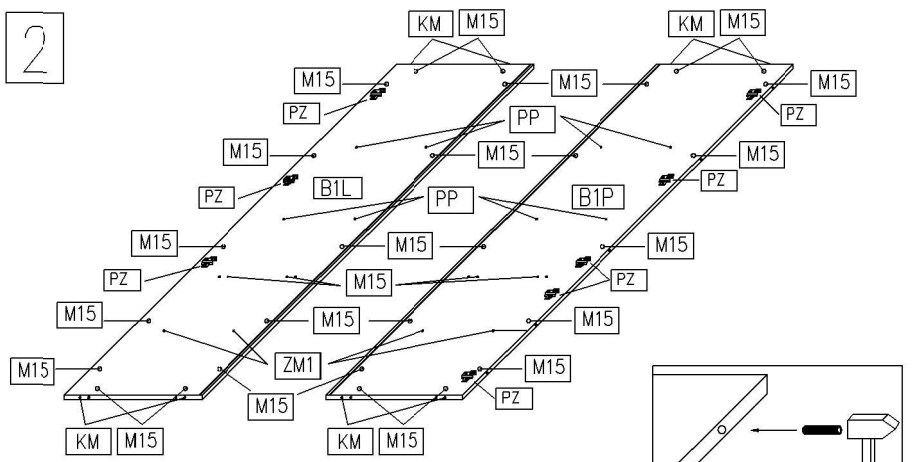
Instructions d'assemblage

**Fig. 1-4.
Assemblage des éléments.**

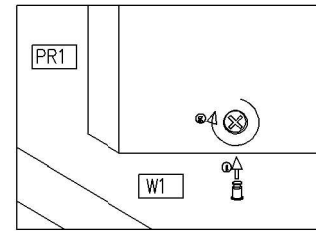


**Fig. n°1
Montage des charnières sur les panneaux vis. 35x16mm.**

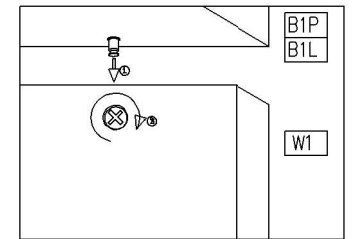
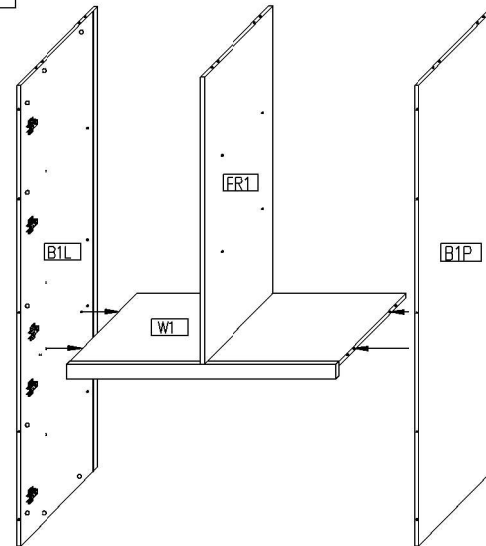
2



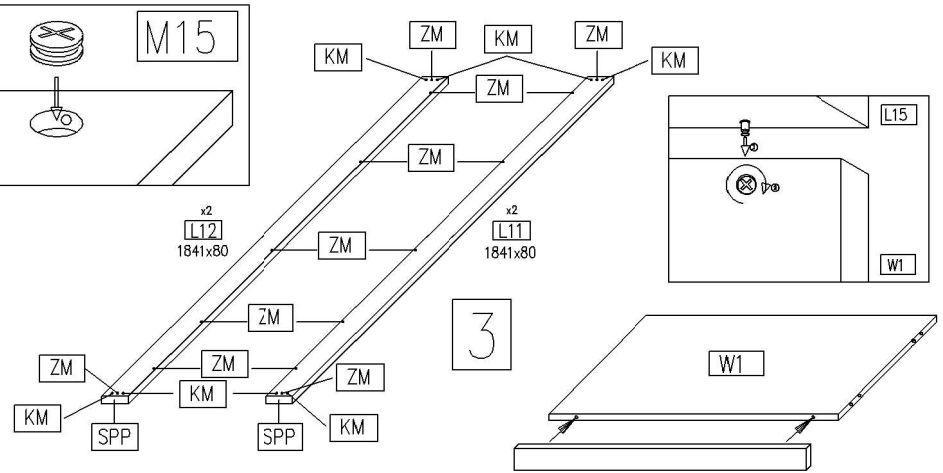
4



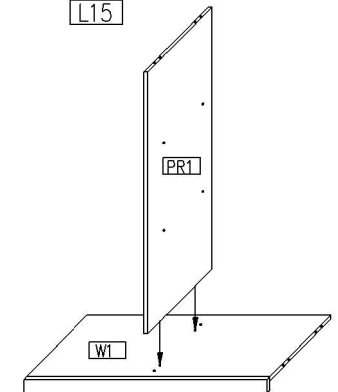
5



3



L15



L15

W1

W1

PR1

W1

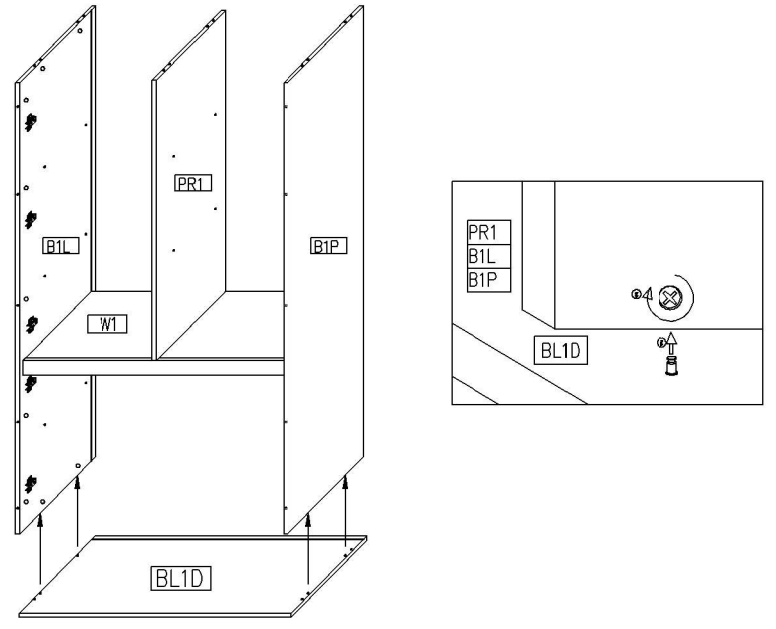
W1

B1P

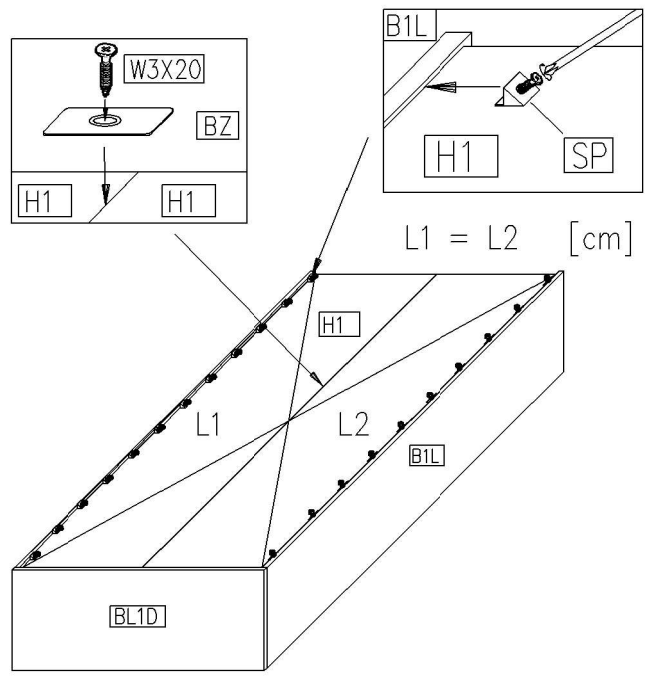
B1L

W1

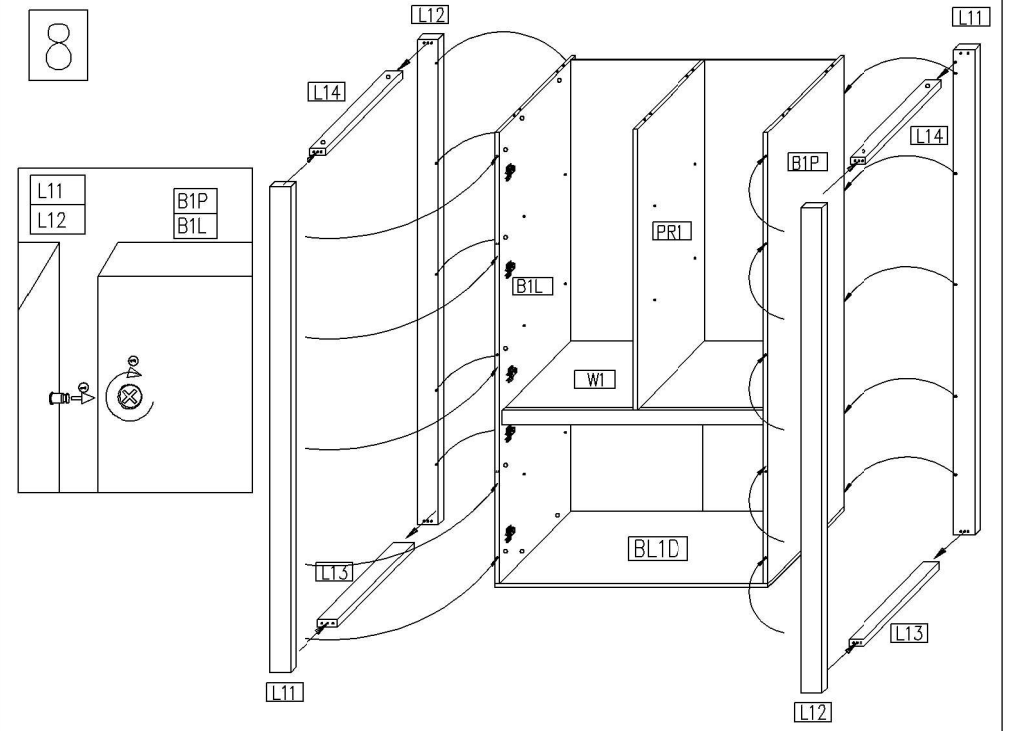
6



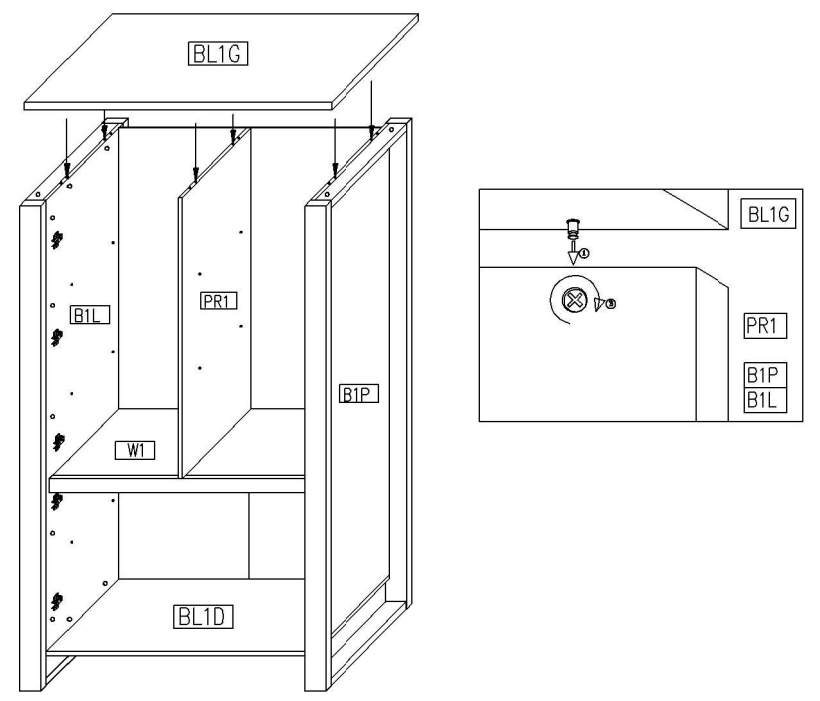
7



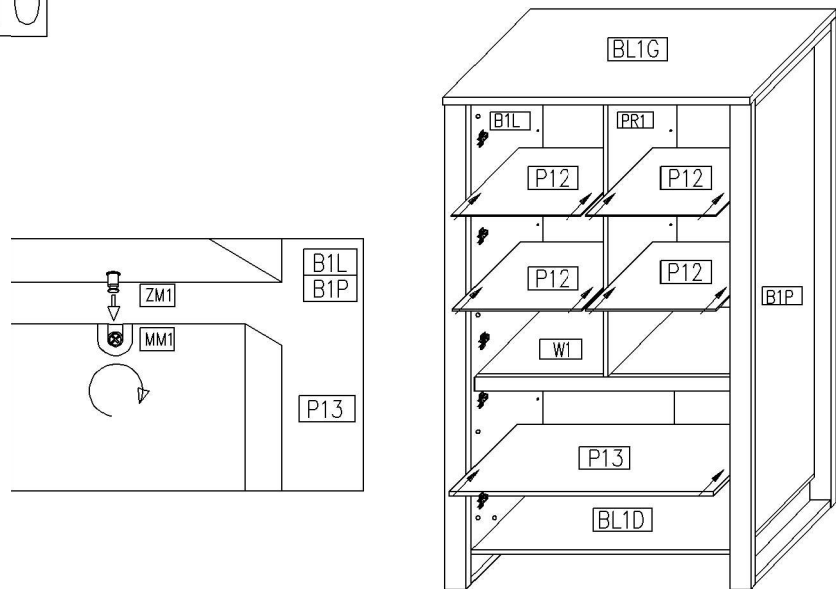
8



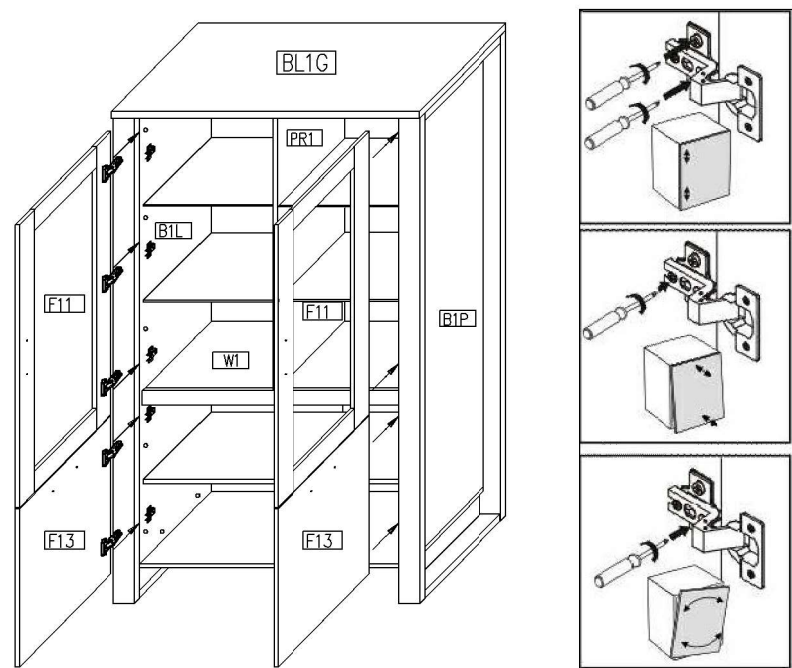
9



10



11



12

